



General Information

Wikk offers a great selection of high quality and customizable INGRESS'R® switch solutions.

With our competitive lead time, stock product ships from the factory in 2-3 business days. Custom made-to-order product ships in 20 business days or less after acknowledgment of a purchase order and approved drawings.

For a list of STOCK INGRESS'R® switches, refer to <https://wikk.com/product-category/ingressr>.

To expedite custom orders to ship in 10 business days, call Wikk's customer service for details.

Specification Summary

The switches to be used throughout the complex shall be Wikk® Industries, Inc. INGRESS'R® activation door control. The INGRESS'R® activation door control shall be ADA compliant and exceed California Building Code, Section 11B404.3. INGRESS'R® shall be such that pressing any part of the actuating column will activate the device. Switches shall be rated at 15A, 125/250VAC; 3/4hp, 125VAC.

To ensure competitive bidding by qualified Sub Contractors, please specify Wikk's products in CSI Divisions: 8, 14, or 28.

Technical:

Standard Dimensions: 6" Wide X LENGTH X 1.62" Deep (152mm X LENGTH X 41mm)

Narrow Dimensions: 4" Wide X LENGTH X 1.62" Deep (102mm X LENGTH X 41mm)

Switch Type: Momentary
Contact Type: Single Pole-Double Throw micro-switch capable of normally open or normally closed operation

Rated: 15 Amp, 125/250 VAC

Compatible Connectivity: Low-energy automatic door operators

Max. Temp Rating: -40°F to 221°F (-40°C to 105°C)

Listed: UL and CSA

Features:

- Contoured profile allows activation from any approach and height level
- Ready for hardwired or wireless products
- Functional for outdoor applications
- Deflects impact from wheeled carts and conveyances
- **NEW** Heat cured ink graphics for improved wear resistance

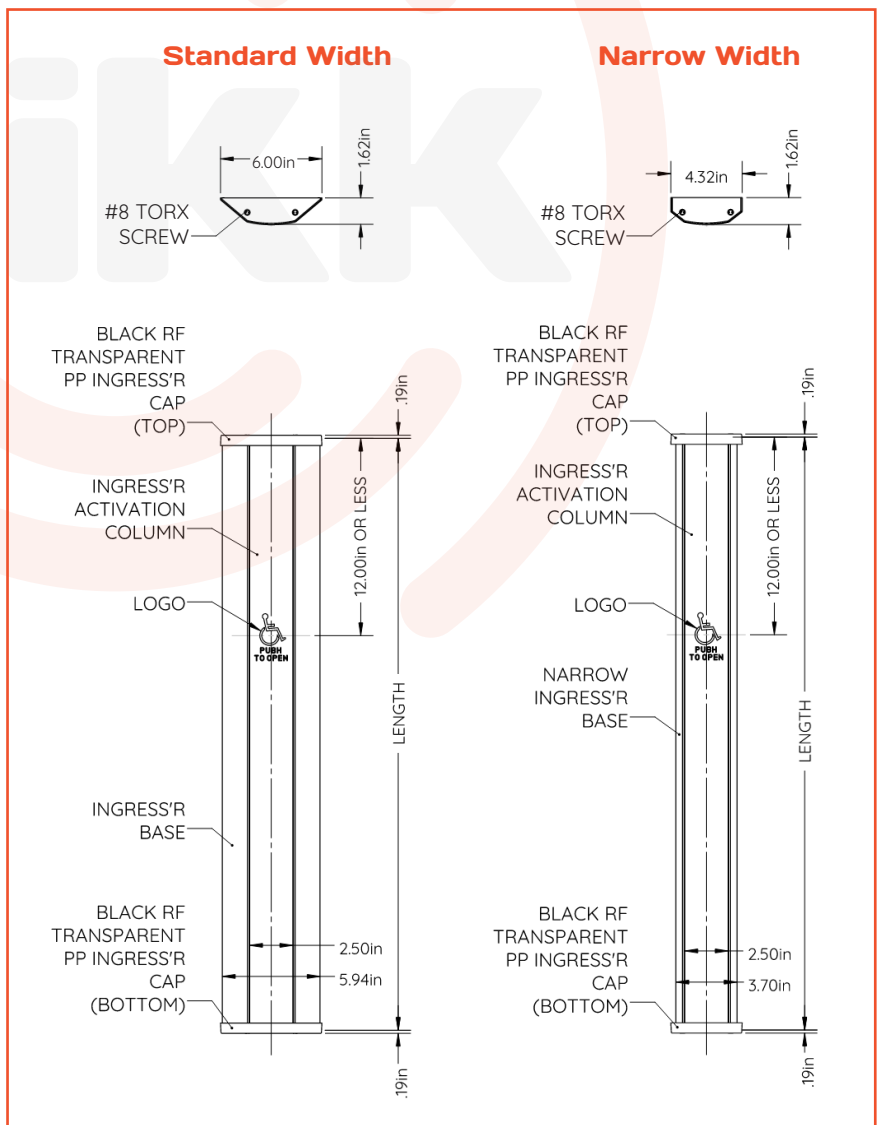



Wikk Part Numbering Guide

When quoting or ordering an INGRESS'R®, follow this convention:

CLASS TYPE - SIZE - LOGO - FINISH - [OPTION] + [OPTION]

Examples: S-I36-3-DB
 S-I42NAR-6-PCCLEAR
 S-I24-1-US32D-SSCAP+LEDW

CLASS TYPE

S Switch

SIZE

I9 9" Length Standard Width
 I9NAR 9" Length Narrow Width
 I12 12" Length Standard Width
 I12NAR 12" Length Narrow Width
 I24 24" Length Standard Width
 I24NAR 24" Length Narrow Width
 I30 30" Length Standard Width
 I30NAR 30" Length Narrow Width
 I36 36" Length Standard Width
 I36NAR 36" Length Narrow Width
 I42 42" Length Standard Width (Aluminum or PC finish only)
 I42NAR 42" Length Narrow Width (Aluminum or PC finish only)

LOGO

0 Blank/No logo
 1 Custom logo
 2 "PUSH TO OPEN"
 3 International Symbol of Access with "PUSH TO OPEN"
 3L Intl. Symbol of Access with "PUSH TO OPEN" & Left Arrow
 3R Intl. Symbol of Access with "PUSH TO OPEN" & Right Arrow
 5 International Symbol of Access only
 5L International Symbol of Access with Left Arrow
 5R International Symbol of Access with Right Arrow
 6 Modified Intl. Symbol of Access with "PUSH TO OPEN"

FINISH

* Standard Width ONLY
 † Not available for 42" lengths

CLEAR* Aluminum 6063-T5, Clear Anodized (628)
 DB* Aluminum 6063-T5, Dark Bronze Anodized (710)
 PCCLEAR Powder Coated to match Clear Anodized
 PCDB Powder Coated to match Dark Bronze Anodized
 PCBLACK Powder Coated Black
 PC Powder Coated Exotic Custom
 US32D † Satin Stainless Steel 304, US32D (630)
 US32 † Mirror Stainless Steel 304, US32 (629)
 US4* † Satin Brass (606)
 US10B* † Oil Rubbed Antique Brass (613)

OPTIONS

SSCAP Stainless steel cap
 PCCAP Powder coated cap (Multiple colors available. Contact Wikk)
 LEDB Blue LED indicator light mounted on cover
 LEDW White LED indicator light mounted on cover
 2P 2 Pole (Additional switch to control two separate circuits)

AVAILABLE AS STOCK [SHIPS IN 2-3 BUSINESS DAYS]:

S-I36-3-CLEAR S-I36-3-DB S-I36NAR-3-PCCLEAR
 S-I36-3-CLEAR-2P S-I36-3-US32D S-I36NAR-3-US32D
 S-I36-5-CLEAR

Logo Options

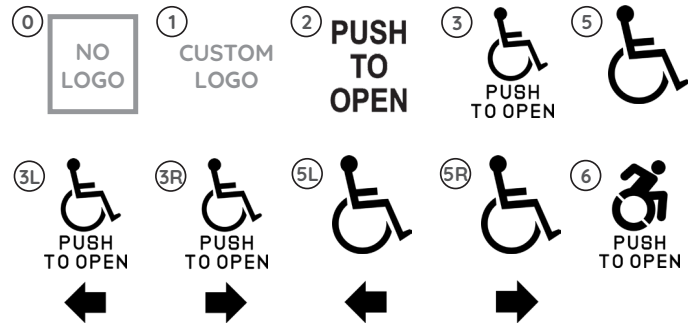

Ink color by finish:

BLUE Clear Anodized Powder Coat Clear Stainless Steel Brass US4
 WHITE Dark Bronze Anodized Powder Coat Dark Bronze Powder Coat Black Brass US10B

Other ink colors available upon request.

Finish Options



Optional Add-ons

SSCAP or PCCAP



LEDB or LEDW

